

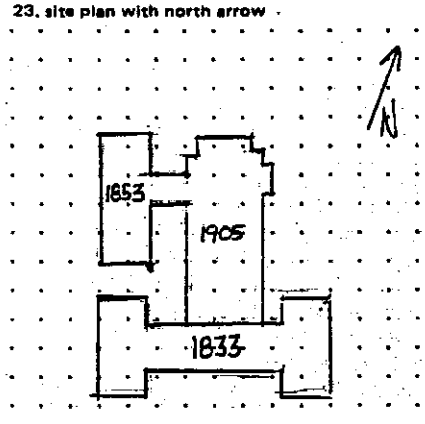

PENNSYLVANIA HISTORIC RESOURCE SURVEY FORM OFFICE OF HISTORIC PRESERVATION Box 1026 PA HISTORICAL & MUSEUM COMMISSION Harrisburg, PA 17120		7. Local survey organization Delaware County Planning Department		5. present name Founders Hall Delaware	1. County Delaware
8. property owners name and address Corporation of Haverford College 629 Haydock Lane Haverford, PA 19041		9. tax parcel number / other number 22 05 00415 00			
12. classification site () structure () object () building 20 in N.R. district yes () no (X)		13. date(s) (how determined) 1833-1853-1905 doc		15. style, design or folk type Colonial Revival	
16. architect or engineer		17. contractor or builder		19. original use Institutional	
18. primary building mat./construction Stucco over stone		21. condition Good		20. present use Institutional	
23. site plan with north arrow 		18. primary building mat./construction Stucco over stone			
24. photo notation Roll 174, 15-20		22. integrity Altered-major			
25. file/location DCPD		23. site plan with north arrow 			
26. brief description (note unusual features, integrity, environment, threats and associated buildings) Nine-bay three story stucco over stone building. First (1833) section 110' long by 28' wide. Covered porch supported by pillars runs across south facade, half-story above ground level. Wings at each end, 50'x28'. Gest Hall 1853, became part of Founders Hall after 1905 connecting addition built. Venetian windows in this rectangular section. Hexagonal cupola on roof of main facade. In 1988-89 the building was gutted on the interior, but the exterior has been preserved to replicate the original: the shades of stucco were matched to the former shades, and triple-pane windows duplicated the original windows.					
27. history, significance and/or background First building of Haverford College, the first college founded by the Society of Friends in the U.S. (Founders were orthodox Quakers.) The institution was first called "Haverford School." There are several historic structures on the present 225 acres of carefully tended grounds. Founders Hall originally housed the dormitories, classrooms and laboratories; currently functions as administration building.					
28. sources of information College records M. E. Johnston, Historian				29. prepared by: S. Hauser K. Wandersee	
30. date 6/83				revision(s) 9/93	
3. street address or specific location College Avenue and Walton Lane					
4. survey code 045-HA-19A					

(continue on back if necessary)

(continue on back if necessary)

(continue on back if necessary)

ADDITIONAL DATA/PHOTOS
number all continuations from front

4. survey code
045-HA-019 A

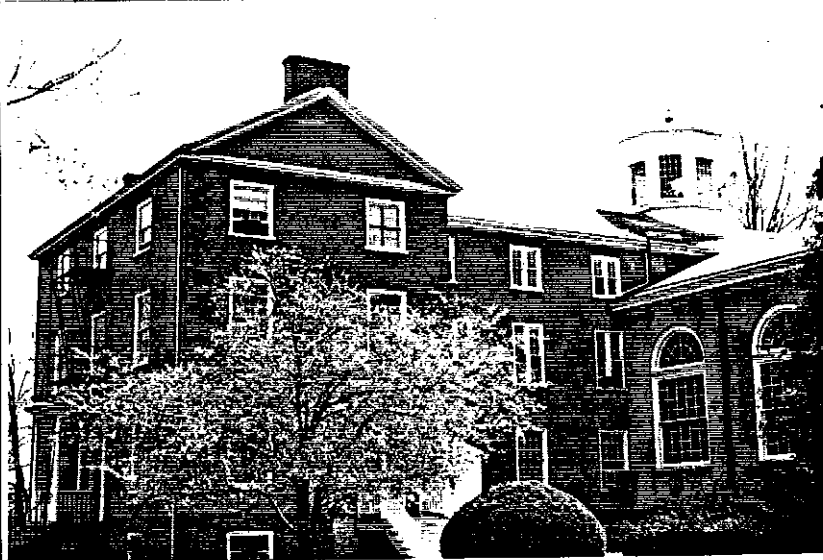
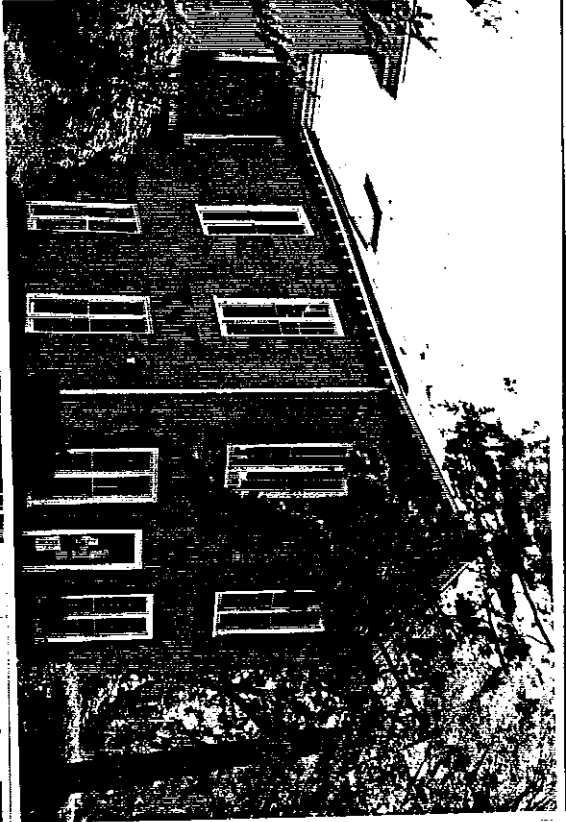

EVALUATION

EVALUATOR(S)

PENNSYLVANIA HISTORIC RESOURCE SURVEY FORM OFFICE OF HISTORIC PRESERVATION Box 1026 PA HISTORICAL & MUSEUM COMMISSION Harrisburg, PA 17120		7. Local survey organization Delaware County Planning Department		1. County Delaware
8. property owners name and address Corporation of Haverford College Haverford, PA 19041		9. tax parcel number / other number 22 05 00415 00	10. U.T.M. zone [18] [471317150] easting [4141218161210] northing usgs sheet: Norristown F	
12. classification site () structure () object () building (X) in N.R. district yes () no (X)		11. status (other surveys, lists etc.) PI		6. other name (historic name if any) Barclay Hall
13. date(s) (how determined) 1877 doc 14. period		15. style, design or folk type colonial revival		
16. architect or engineer		17. contractor or builder		3. street address or specific location College Ave. & Walton Lane
18. primary building mat./construction stone		19. original use Institutional 20. present use Institutional		
21. condition Good		22. integrity unaltered		
23. site plan with north arrow 				
24. photo notation Roll 174-21; 175-2				
25. file/location DCPD				
26. brief description (note unusual features, integrity, environment, threats and associated buildings) Large 21-bay 3-story stone building with plain slate roof built in 1877. Interior chimneys at center of gable ends and in center of central hall.				
(continue on back if necessary)				
27. history, significance and/or background Part of Haverford College, first college founded by the Society of Friends in the U.S.				
(continue on back if necessary)				
28. sources of information		29. prepared by: S. Hauser		
		30. date 6/83		revision(s)
(continue on back if necessary)				

ADDITIONAL DATA/PHOTOS
number all continuations from front



4. survey code

045-HA-019 B



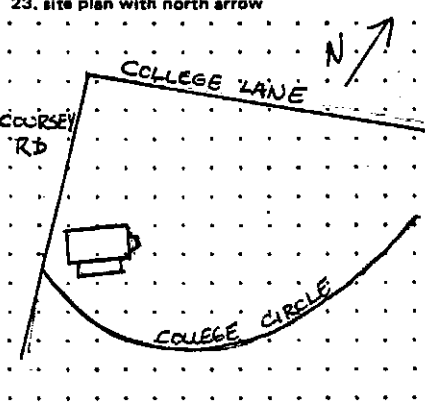

EVALUATION

EVALUATOR(S)

PENNSYLVANIA HISTORIC RESOURCE SURVEY FORM OFFICE OF HISTORIC PRESERVATION Box 1026 PA HISTORICAL & MUSEUM COMMISSION Harrisburg, PA 17120		7. Local survey organization Delaware County Planning Department		1. County Delaware
8. property owners name and address Corporation of Haverford College Haverford, PA 19041		9. tax parcel number / other number 22 05 00415 00		
12. classification site () structure () object () building <input checked="" type="checkbox"/> In N.R. district yes () no (<input checked="" type="checkbox"/>)		10. U.T.M. zone [18] [4713171510] easting [4428] [6210] northing U.S.G.S. sheet: Norristown F		2. municipality Haverford
13. date(s) (how determined) 1904 doc.		11. status (other surveys, lists etc.) PI		
14. period		15. style, design or folk type Shingle Style		3. street address or specific location Coursey Road
16. architect or engineer Price, Walter F.		17. contractor or builder		
18. primary building mat./construction wood shingle		19. original use Recreational		
20. present use Recreational		21. condition Good		
22. integrity unalt.		23. site plan with north arrow 		24. photo notation 175, #3
25. file/location DCPD				
26. brief description (note unusual features, integrity, environment, threats and associated buildings) 7-bay 1-story wood shingle building with 4-window bay on NE facade. Half-circle window above attic. Single centered main entrance, porch across main facade supported by shingled posts. Pavilion overlooks Cricket field.				
(continue on back if necessary)				
27. history, significance and/or background First inter-collegiate cricket game played at Haverford. Still an important sport at the College.				
(continue on back if necessary)				
28. sources of information College Records			29. prepared by: S. Hauser	
(continue on back if necessary)			30. date 6/83	
			revision(s)	

PENNSYLVANIA HISTORIC RESOURCE SURVEY FORM OFFICE OF HISTORIC PRESERVATION Box 1026 PA HISTORICAL & MUSEUM COMMISSION Harrisburg, PA 17120		7. Local survey organization Delaware County Planning Department		1. County Delaware	
8. property owners name and address Corporation of Haverford College Haverford, PA 19041		9. tax parcel number / other number 22 05 00415 00	10. U.T.M. zone 18 4 7 3 7 5 0 4 4 2 8 6 2 0 existing northing		Representative name Carvill Arch
12. classification site () structure () object <input checked="" type="checkbox"/> building () in N.R. district yes () no <input checked="" type="checkbox"/>		13. date(s) (how determined) 1834	14. period	15. style, design or folk type	19. original use Institutional
16. architect or engineer		17. contractor or builder		18. primary building mat./construction Same	20. present use Decorative
21. condition Ruins		22. integrity		2. municipality Haverford	
23. site plan with north arrow 					6. other name (historic name if any)
24. photo notation 175 #3		25. file/location DCPD			3. street address or specific location
26. brief description (note unusual features, integrity, environment, threats and associated buildings) Stone arch - remains of 1834 greenhouse <p style="text-align: right;">(continue on back if necessary)</p>					
27. history, significance and/or background Remains of one of the original structures on the Haverford College Campus, the first college founded by the Society of Friends in the U.S. The handsomely landscaped, well-tended grounds of the college are well known and the remains of the early greenhouse attest to its horticultural history. The "arch" is named for William Carvill who not only landscaped the college but introduced the sport of cricket to the area. <p style="text-align: right;">(continue on back if necessary)</p>					
28. sources of information		29. prepared by: S. Hauser			4. survey code 045-HA-19D
30. date 6/83		revision(s)			

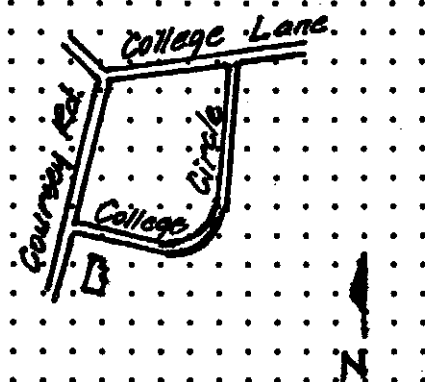
(continue on back if necessary)

PENNSYLVANIA HISTORICAL RESOURCE SURVEY FORM BUREAU FOR HISTORICAL PRESERVATION Box 1026 PA HISTORICAL & MUSEUM COMMISSION Harrisburg, PA 17120		7. Local Survey Organization Delaware County Planning Department		5. Present Name Delaware
8. Property Owner's Name and Address Haverford College, Corporation of Haverford, Pa. 19041		9. Tax Parcel Number/Other Number 22-05-0415-00		
12. Resource Count buildings (1) district (1) sites () structures () objects () intrusions ()		10. U.T.M. zone easting 18 473750 4428620 Usgs Sheet: Lansdowne (F) northing		6. Other Name (historic name if any) Haverford
13. Date(s) (how determined) 1860, doc. 1880, 1920, est.		11. Status (Other Surveys, Lists, Etc.) PI		
14. Period		15. Style, Design or Folk Type Greek Revival Vernacular		19. Original Use Residence 20. Present Use Residence
16. Architect or Engineer		17. Contractor or Builder		
18. Primary Building Mat./Construction Stucco over Stone		21. Condition Good 22. Integrity Unaltered		3. Current Address or Specific Location 6 College Circle Haverford College Haverford, Pa.
23. Site Plan with North Arrow 				
24. Photo Notation Roll 175, Fr. 10-12		25. File/Location DCPD		
26. Brief Description (note unusual features, integrity, environment, threats and associated buildings) 1860: 5 bay, 2 sty, central covered entry, gable end w/end exterior chimney on NW elevation. 2sty ell addition c. 1880 which also added flush end chimney on SE 5 bay portion. Circa 1920 addition of 1 bay, 2sty, flat roof frame addition w/wood and stucco siding; 1 sty attached deck. 1860 portion has unusual paired 6/6 windows to either side of entry. Center entry possesses transom light; 1 sty entry portico is hipped roof w/ chamfered squared columns and Doric capitals. Rear ell has attic level luminate fanlight. Between ell and main wings on rear elevation is a one sty shed roof porch w/pent roof eave; porch is supported by one round				
27. History, Significance and/or Background College professor's residence constructed in 1860 according to college records. Part of the faculty housing constructed at Haverford College on College Circle. Haverford College was the first college founded by the Society of Friends in the United States. The college underwent a period of expansion in the late 19th and early 20th centuries with construction of classrooms, dining halls, dormitories, and faculty housing.				
28. Sources of Information M.E. Johnston, Board of Managers Records		29. Prepared By: S.M. Clark K. Wandersee		30. Date 12 Feb 83
(continue on back if necessary)		Revision(s) 8/93		

PENNSYLVANIA HISTORICAL RESOURCE SURVEY FORM BUREAU FOR HISTORICAL PRESERVATION Box 1026 PA HISTORICAL & MUSEUM COMMISSION Harrisburg, PA 17120		7. Local Survey Organization Delaware County Planning Department		1. County Delaware																
8. Property Owner's Name and Address Corporation of Haverford College Haverford, PA 19041		9. Tax Parcel Number/Other Number 22-09-00415-00		10. U.T.M. zone <table border="1"><tr><td>1</td><td>8</td></tr></table> easting <table border="1"><tr><td>4</td><td>7</td><td>3</td><td>7</td><td>5</td><td>0</td></tr></table> northing <table border="1"><tr><td>4</td><td>4</td><td>2</td><td>8</td><td>6</td><td>2</td><td>0</td></tr></table> Usage Sheet: Norristown (F)		1	8	4	7	3	7	5	0	4	4	2	8	6	2	0
1	8																			
4	7	3	7	5	0															
4	4	2	8	6	2	0														
12. Resource Count buildings (1) district (1) sites () structures () objects () intrusions ()		13. Date(s) (how determined) c.1890-1900		15. Style, Design or Folk Type Shingle Style																
16. Architect or Engineer		17. Contractor or Builder		19. Original Use Residence																
18. Primary Building Mat./Construction Brick, wood shingle/frame		20. Present Use Residence		21. Condition Very good																
22. Integrity Unaltered		23. Site Plan with North Arrow 		2. Municipality Haverford																
24. Photo Notation 175, 4				6. Other Name (historic name if any)																
25. File/Location DCPD		26. Brief Description (note unusual features, integrity, environment, threats and associated buildings) 4 bay, 2½ story, multiple gable & hipped asphalt shingle roof. w/shed roof dormer & 2 massive chimneys; 1 interior, 1 corner. Wrap-around porch w/projecting hip roof canti-cornered to main structure. 1st story: thin brick with narrow mortar joints on stone foundation, excluding projecting oriel (wood siding). 2nd story: squared cedar shingle w/2 distinctive splays (bell-cast). ½ story: wave pattern cedar shingle splaying out over 2nd story. Wave continues full height in one gable, other gable exhibits half-lunate sash with two distinctive splays. Oriel possesses 3 paired windows w/four distinctive splays culminating in shed roof dormer. (continue on back if necessary)		3. Street Address or Specific Location No. 3 College Circle Haverford College Haverford, PA																
27. History, Significance and/or Background Constructed in c.1890-1900 this residence is part of the Haverford College faculty complex. Haverford College is the first college in the U. S. founded by the Society of Friends. The college underwent a period of expansion in the late 19th-early 20th centuries with construction of classrooms, dining halls, dormitories, and faculty housing. (continue on back if necessary)		28. Sources of Information M. E. Johnston Board of Managers Records		29. Prepared By: S. Clark																
30. Date 12 Feb 83		Revision(s)		4. Survey Code 045-HA-019F																

PENNSYLVANIA HISTORICAL RESOURCE SURVEY FORM
BUREAU FOR HISTORICAL PRESERVATION Box 1026
PA HISTORICAL & MUSEUM COMMISSION Harrisburg, PA 17120

7. Local Survey Organization

Delaware County Planning Department

8. Property Owner's Name and Address

Haverford College
Haverford, PA 19041

9. Tax Parcel Number/Other Number

22-05-00415-00

10.

1 8 4 7 3 7 5 0

U.T.M.

zone

easting

4 4 2 8 6 2 0

Usgs

Sheet:

northing

Norristown (F)

11. Status (Other Surveys, Lists, Etc.)

P.I.

15. Style, Design or Folk Type

Queen Anne
Eclectic

19. Original Use

Residence

20. Present Use

Residence

12. Resource Count

buildings (1) district (1)
sites () structures ()
objects () intrusions ()

13. Date(s) (how determined)

c.1890-1900, est.

14. Period

16. Architect or Engineer

17. Contractor or Builder

18. Primary Building Mat./Construction

Stone, Wood Shingle
over Stone & Frame

21. Condition

Excellent

22. Integrity

Unaltered

23. Site Plan with North Arrow

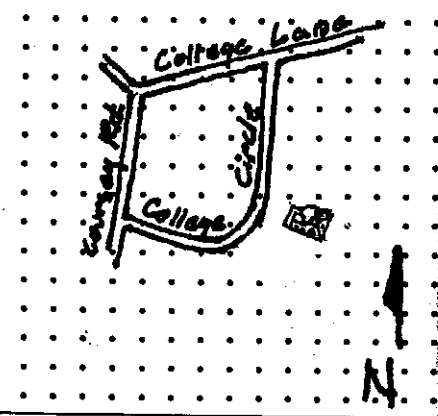

24. Photo Notation

Roll 175, Fr. 5,6

25. File/Location

DCPD

26. Brief Description (note unusual features, integrity, environment, threats and associated buildings)

2 1/2 sty asymmetrical shape w/steeply pitched wood shingle roof. Roof of varying shapes/forms w/ massive chimney and roof cresting. Queen Anne style predominant but eclectic styles are chateausque and Tudor.

1st floor: rough finish, uniform laying face laid in random, varying bond; wrap-around porch, modified palladian window under porch and in rounded bay on north elevation (1st & 2nd floors). 2nd Floor: sided in squared-off wood shingles; modified Palladian window in rounded bay (North elevation) paired windows on front facade, projecting two sided bay w/diamond pane 12 lite/1 sash. 1/2 story: projecting gable has fish scale

(continue on back if necessary)

27. History, Significance and/or Background

Haverford College professor's residence. Haverford was the first college in the United States founded by the Society of Friends. The college underwent a period of expansion in the late 19th-early 20th centuries with construction of classrooms, dining halls, dormitories, and faculty housing.

(continue on back if necessary)

28. Sources of Information

M.E. Johnston, Board of Managers Records

29. Prepared By:

S.M. Clark

30. Date

Revision(s)

12 Feb 83

(continue on back if necessary)

1. County: Delaware
2. Municipality: Haverford
3. Street Address or Specific Location: No. 2 College Circle, Haverford College, Haverford, PA 19041
4. Survey Code: 045-HA-019G
5. Present Name: Haverford College
6. Other Name (historic name if any):

26. Cont'd. and squared shingles, triparte window on front facade 4/6 lite separated by transom bar w/ tudor motif between these and 2nd story; paired lites. Plain solid vergeboards w/dentiling, eyebrow dormer and pent roof dormer w/6 lite casement window/transom bar/6 lite pivot window. Open air porch under 2nd floor at S elevation, rear corner; built as part of first floor.



; ; ; ; ;
 ; 36. Survey Date (Year)
 ; ;
 P

42. Individual 1

Individual 2

43. Status: 101 Potential NR; 102 Part of Potential district; ; ; ;

44. Design Type: 01 High Style; 02 Style Elements; 03 Popular Vernacular; 04 Traditional (Folk); 05 Utilitarian;

45. Ext. Walls ; 46. Roof Material 47. Plan 48. Stories

49. Facade Width

50. Construction Feature ; ;

51. Ext. Design Feature ; ;



52. Int. Design Feature ; ;

53. Comment _____

EVALUATION

EVALUATOR(S)

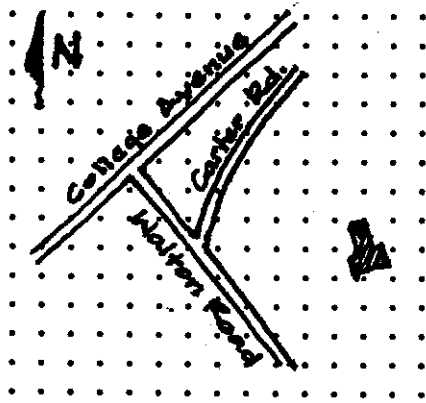
PENNSYLVANIA HISTORICAL RESOURCE SURVEY FORM BUREAU FOR HISTORICAL PRESERVATION Box 1026 PA HISTORICAL & MUSEUM COMMISSION Harrisburg, PA 17120		7. Local Survey Organization Delaware County Planning Department		1. County Delaware (possibly Montgomery)	
8. Property Owner's Name and Address Corporation of Haverford College Haverford, Pa. 19041		9. Tax Parcel Number/Other Number 22-05-00415-00		10. U.T.M. zone easting 18 473750 northing 4428620 Usgs Sheet: Norristown (F)	
12. Resource Count buildings (1) district (1) sites () structures () objects () intrusions ()		13. Date(s) (how determined) 1857, etc., c1860-80		14. Period	
15. Style, Design or Folk Type Italianate Vernacular		19. Original Use Residence		20. Present Use Residence	
16. Architect or Engineer		17. Contractor or Builder		21. Condition Excellent	
18. Primary Building Mat./Construction 1857: Field stone 1880: wd sid/frame		22. Integrity Unaltered		2. Municipality Haverford Haverford-Gummera House	
23. Site Plan with North Arrow 					
24. Photo Notation Roll 175, Fr. 7-9		3. Street Address or Specific Location 9 College Lane Haverford, Pennsylvania			
25. File/Location DCPD		4. Survey Code 045-HA-019H			
26. Brief Description (note unusual features, integrity, environment, threats and associated buildings) 1857: 3 bay, 2 sty, center entry, two over two plan. Gable end roof w/flush end chimneys (massive), overhanging eaves (all sides) w/Italianate bracketing. 1st Flr: front facade wrap-around porch (c. 1880) w/dentils and square chamfered porch columns. 1857 & 1880: Rear; asymmetrical in plan, multiple 2sty ell additions w/both gable (varying pitch) and flat roofs. Use of Italianate and dentil bracketing, 3 corner chimneys (massive). Varying window patterning: 4/4, 1/1, 6 lite side-by-side, Multiple lites in added sun room (rear elevation). <i>(continue on back if necessary)</i>					
27. History, Significance and/or Background Haverford College professor's residence. Haverford College was the first college in the United States founded by the Society of Friends. <i>(continue on back if necessary)</i>					
28. Sources of Information M.E. Johnston, Board of Managers Records				29. Prepared By: S.M. Clark	
30. Date 12 Feb 83				Revisor(s)	
<i>(continue on back if necessary)</i>					

PENNSYLVANIA HISTORICAL RESOURCE SURVEY FORM BUREAU FOR HISTORICAL PRESERVATION Box 1026 PA HISTORICAL & MUSEUM COMMISSION Harrisburg, PA 17120		7. Local Survey Organization Delaware County Planning Department		1. County Delaware	
8. Property Owner's Name and Address Haverford College Haverford, PA 19041		9. Tax Parcel Number/Other Number 22-09-00415-00		10. U.T.M. zone easting 18 473750 4428620 Usqs Sheet: Norristown F.	
12. Resource Count buildings (1) district (1) sites () structures () objects () intrusions ()		13. Date(s) (how determined) 1888 documented		11. Status (Other Surveys, Lists, Etc.) PI	
14. Architect or Engineer		14. Period		15. Style, Design or Folk Type Richardsonian Romanesque	
16. Architect or Engineer		17. Contractor or Builder		18. Primary Building Mat./Construction Stone	
19. Original Use Instructional		20. Present Use Instructional		21. Condition Good	
22. Integrity Unaltered		22. Integrity Unaltered		5. Present Name Haverford College - Chase Hall	
23. Site Plan with North Arrow 		23. Site Plan with North Arrow 		2. Municipality Haverford	
24. Photo Notation Roll 175, Fr. 14, 15		25. File/Location DCPD		6. Other Name (historic name if any) Haverford College - Chase Hall	
26. Brief Description (note unusual features, integrity, environment, threats and associated buildings) 3 bay, 2½ story, asphalt-shingled, hipped bell-cast roof, parapeted wall dormers w/two massive interior chimneys; projecting off-center ell, 5 bay, 2½ story, asphalt-shingled hipped bell-cast roof w/centered octagonal cupola (wood shingle), and parapeted wall dormers, constructed of rough-cut, random-laid, field stone. W/dressed limestone sills, lintels, corner blocks, parapets. 1st storey main facade: water table ends at corner blocks of semi-circular entrance. Field stone radiates from recessed double door/sidelights entrance, capped by semi-circular lintel. 2nd story, belt course at window sill level; surrounds bldg. Windows 1/1.		27. History, Significance and/or Background Constructed in 1888, addition in 1915, remodelled 1951-52, the hall was named after Thomas Chase, past president of the College. It was originally constructed for science classrooms, but was totally remodelled in 1988-89 for the Dean and Registrar's offices. Chase Hall is part of the Haverford College campus, the first school in the United States founded by the Society of Friends in 1837. The Hall is an example of the growth of the College in the late 19th-early 20th C. which saw numerous campus and residential buildings being erected on the College Grounds.		3. Street Address or Specific Location Haverford College Haverford, PA 19041	
28. Sources of Information M. E. Johnston Board of Managers Records Haverford College, Special Collections.		29. Prepared By: S. Clark		4. Survey Code 045-HA-0191	
30. Date Feb 8 1983		Revision(s)		(continue on back if necessary)	

ADDITIONAL DATA/PHOTOS
number all continuations from front

4. Survey Code

045-HA-019 I



; ; ; ; ;
 ; 36. Survey Date (Year)
 ; ;
 P

39. Secondary Use S; S; S

40. Associated With A; A; A

41. Event 1

Event 2

42. Individual 1

Individual 2

43. Status: 101 Potential NR; 102 Part of Potential district; ; ; ;

44. Design Type: 01 High Style; 02 Style Elements; 03 Popular Vernacular; 04 Traditional (Folk); 05 Utilitarian;

45. Ext. Walls ; 46. Roof Material 47. Plan 48. Stories

49. Facade Width

50. Construction Feature ; ;

51. Ext. Design Feature ; ;

52. Int. Design Feature ; ;

53. Comment _____

EVALUATION

EVALUATOR(S)

PENNSYLVANIA HISTORIC RESOURCE SURVEY FORM BUREAU FOR HISTORIC PRESERVATION Box 1026 PA HISTORICAL & MUSEUM COMMISSION Harrisburg, PA 17120		7. Local survey organization Delaware County Planning Department		1. County Delaware 2. Municipality Haverford 3. Street address or specific location Haverford College Library 4. Survey code 045-HA-019J
8. Property owners name and address Haverford College Haverford, PA 19041		9. Tax parcel number / other number 22-09-00415-00		
12. Classification site () structure () object () building (x) In N.R. district yes () no ()		10. U.T.M. Zone 18 Easting 47371510 Northing 42286210 usgs sheet: Norristown (F)		
13. date(s) (how determined) 1864, 98, 1912, 41, 51		11. status (other surveys, lists etc.) P.I.		
14. period 1837-1990		15. style, design or folk type Gothic Revival Vernacular		
16. architect or engineer 1910-E. Nelson Edwards		17. contractor or builder		
18. primary building mat./construction Stone		19. original use Library		
20. present use Library		21. condition Good		
22. integrity Altered/additions		23. site plan with north arrow 		
24. photo notation Roll 175, Fr. 16 Roll 905, Fr. 38				
25. file/location DCPD		26. brief description (note unusual features, integrity, environment, threats and associated buildings) <p>1 story, multiple gable, with flush chimneys, steeply pitched slate roof. The 1898 portion is the south wing with 1864 portion intersecting at base. Additions of 1912-1952 architecturally blended. The two earliest portions are of random-laid dressed fieldstone with parapeted buttresses at corners. The 1864 section has 3 point arched five over four double hung lights in NE elevation and 12 over 12 light double hung in North elevation. The 1898 end gable has 3 point arched five over four double hung in Palladian style windows. At intersection of earliest sections is round arch entry. To the west is the 1952 addition.</p>		
27. history, significance and/or background <p>Originally constructed in 1864 for the faculty and students of Haverford the library has gone through numerous additions and alterations. The south wing is the 1898 section with the north wing built in 1864. In 1912 an old stack was added, and in 1941 the new stack was added and the old stack converted to the Treasure Room. In 1952 the Phillips Memorial Wing was sensitively incorporated with the two original sections.</p>		(continue on back if necessary)		
28. sources of information M.E. Johnston Board of Managers Records		29. prepared by: K. Wandersee S. Clark		
30. date 12/83		revision(s) 9/93		
(continue on back if necessary)		(continue on back if necessary)		

ADDITIONAL DATA/PHOTOS
number all continuations from front



4. survey code



045-HA-019J

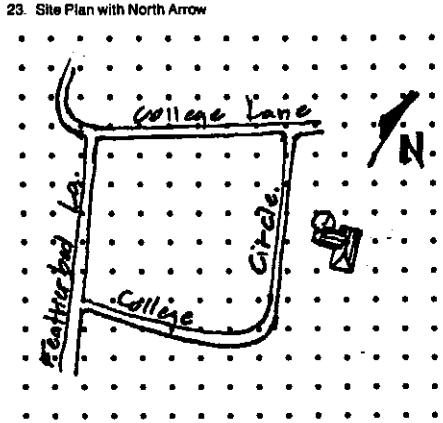

EVALUATION

EVALUATOR(S)

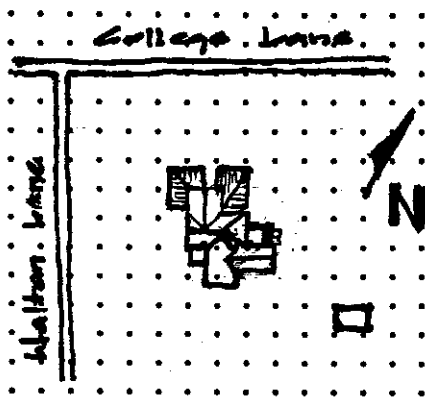
PENNSYLVANIA HISTORICAL RESOURCE SURVEY FORM BUREAU FOR HISTORICAL PRESERVATION Box 1026 PA HISTORICAL & MUSEUM COMMISSION Harrisburg, PA 17120		7. Local Survey Organization Delaware County Planning Department		1. County Delaware	
B. Property Owner's Name and Address Corporation of Haverford College Haverford, Pa. 19041		9. Tax Parcel Number/Other Number 22-09-00415-00		10. U.T.M. zone easting 18 473750 4228620 Usgs Sheet: Norristown (F)	
12. Resource Count buildings () district () sites () structures () objects () intrusions ()		13. Date(s) (how determined) 1895, est. 14. Period 1800-1920		15. Style, Design or Folk Type Shingle Style	
16. Architect or Engineer		17. Contractor or Builder		18. Primary Building Mat./Construction Random cut/laid stone, shingle	
19. Original Use Residence		20. Present Use Residence		21. Condition Excellent	
22. Integrity Unaltered		23. Site Plan with North Arrow 		2. Municipality Haverford	
24. Photo Notation Roll 905, Fr. 40,41				3. Street Address or Specific Location 1 College Circle Haverford, Pa. 19041	
25. File/Location DCPD		26. Brief Description (note unusual features, integrity, environment, threats and associated buildings) 5 bay, 2½ sty, random cut & laid stone ground story, shingle sided second and half stories, gambrel and hipped roofs and dormer roofs, interior chimney, assymetrical plan and detailing, 1 sty entrance porch. Executed in the Shingle style the ground story is comprised of random cut and laid fieldstone, front entry is recessed under massive hexagonal, corner one story entry porch, roof of porch undulates to corner apex, ribbon windows in front. Second story: Use of oriel in north elevation, tower in west elevation (left of porch) that is extension of wall surface, South elevation hipped roof begins at apex of first floor; extends to		4. Survey Code 045-HA-019 K	
27. History, Significance and/or Background Part of the Haverford College complex. Haverford College is the oldest school founded by the Society of Friends in the United States, having been founded in 1837. The College went through a major period of expansion in the late 19th-early 20th C. which included classroom space, dormitory space, and faculty housing. The President's House is an example of this expansionism, as are the remaining housing along College Circle.		28. Sources of Information M.E. Johnston, S Clark		29. Prepared By: S. Clark	
30. Date 15 Ag 90		Revisor(s)		(continue on back if necessary)	

PENNSYLVANIA HISTORICAL RESOURCE SURVEY FORM BUREAU FOR HISTORICAL PRESERVATION Box 1026 PA HISTORICAL & MUSEUM COMMISSION Harrisburg, PA 17120		7. Local Survey Organization Delaware County Planning Department		1. County Delaware
8. Property Owner's Name and Address Corporation of Haverford College Haverford, Pa. 19041		9. Tax Parcel Number/Other Number 22-04-00097-58	10. U.T.M. zone easting 18 473548 4428743 northing Sheet: Norristown (F)	5. Present Name Haverford
12. Resource Count buildings (1) district () sites () structures () objects () intrusions ()	13. Date(s) (how determined) C. 1888-1890	15. Style, Design or Folk Type Queen Anne Eclectic	19. Original Use Residence	2. Municipality Haverford
16. Architect or Engineer	14. Period	18. Primary Building Mat./Construction Brick/brick & frame	20. Present Use Residence	6. Other Name (historic name if any)
11. Status (Other Surveys, Lists, Etc.)	17. Contractor or Builder	21. Condition Excellent	22. Integrity altered-minor	3. Street Address or Specific Location 791 College Avenue Haverford, Pa.
23. Site Plan with North Arrow 				
24. Photo Notation Roll 905, Fr. 1-3		25. File/Location DCPD		
26. Brief Description (note unusual features, integrity, environment, threats and associated buildings) 4 bay, 2½ sty, 4 piles deep, assymmetrical plan; steeply pitched pryamidal and cross gabled roof, gable end dormers; use of polychrome and patterned brick. Queen Anne style with Late Victorian Gothic; latter style evident in steeply pitched roofs, open rakes and eaves, heavy unadorned verge-boards. Queen Anne parent style, but early interpretation, through use of assymmetrical massing, hipped roof, patterned and polychrome brick, and multipaned designed sashes over single sash (12 lites surrounding larger single lite over single lite) in ground sty; upper stys 12/1. Ground sty: Two, 1 sty hipped roof porches separated byprojecting gable-ended wing. <small>(continues on back if necessary)</small>				
27. History, Significance and/or Background Part of the Haverford College campus; this college is the first college in the United States founded by the Society of Friends. This building is also representative of the late nineteenth century expansion undertaken by Haverford College which extended into the early 20th century. <small>(continue on back if necessary)</small>				
28. Sources of Information S. Clark, 1877,81,92,etc. Atlases of Delaware County		29. Prepared By: S. Clark		
<small>(continue on back if necessary)</small>		30. Date 15 Ag 90	Revision(s)	
4. Survey Code 045-HA-19 L				

PENNSYLVANIA HISTORICAL RESOURCE SURVEY FORM
BUREAU FOR HISTORICAL PRESERVATION Box 1026
PA HISTORICAL & MUSEUM COMMISSION Harrisburg, PA 17120

7. Local Survey Organization
 Delaware County Planning Department

1. County
 Delaware

8. Property Owner's Name and Address
 Society of Friends
 Haverford, Pa. 19041

9. Tax Parcel Number/Other Number
 22-05-910140-00

10.

1	8	4	7	3	6	3	0
---	---	---	---	---	---	---	---

 U.T.M. zone easting

11. Status (Other Surveys, Lists, Etc.)
 PI

4	4	2	9	0	3	5
---	---	---	---	---	---	---

 Usgs Sheet: Lansdowne (E)
 northing

5. Present Name
 Buck Lane Meeting

12. Resource Count
 buildings () district ()
 sites () structures (2)
 objects () intrusions ()

13. Date(s) (how determined)
 1834, 1894, 1903, documented

15. Style, Design or Folk Type
 Colonial
 Vernacular

18. Original Use
 House of Worship

16. Architect or Engineer

17. Contractor or Builder

18. Primary Building Mat./Construction
 Stucco over Stone

20. Present Use
 House of Worship

21. Condition
 Excellent

22. Integrity
 Altered

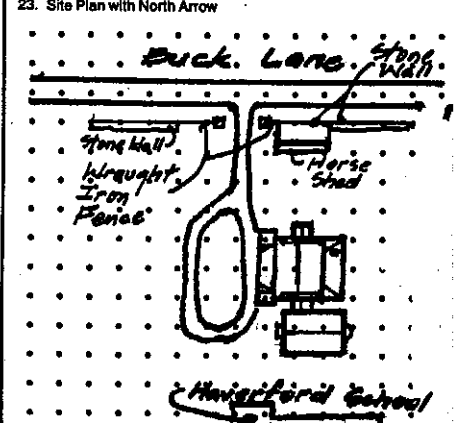

2. Municipality
 Haverford

24. Photo Notation
 Roll 390, Fr. 39-43
 Roll 159, Fr. 7A

6. Other Name (historic name if any)
 Buck Lane Meeting

25. File/Location
 DCPD

3. Street Address or Specific Location
 851 Buck Lane
 Haverford, Pa.

26. Brief Description (note unusual features, integrity, environment, threats and associated buildings)
 Three distinct styles; 1834: 5 bay, 1 sty, gable end structure w/semi-circular multi-paned lights in gable ends above pent eaves. The main block has 2 entries centered between the 5 bays. 1894: Carpenter gothic porch added over 5 bays. Porch is hipped with two cross gables at each end. 1903: 1½ sty, 3 bay gable end unit added; at same time connector wing and end side entry (1834 portion) were added. These last additions used classical revival elements; closed triangular pediments, modillions, dentilling, pilasters, radiating voussoirs, keystones, and multi-paned semicircular transom sash and sidelights, palladian windows
 (continue on back if necessary)

27. History, Significance and/or Background
 Meeting House built after the Hicksite division of the Society of Friends split off from the Main body of the Society. The split occurred in 1827 with the worship house being constructed in 1834. As well, the meeting house was also the first site of Haverford College classes; they being held on Dec. 11, 1834. This meeting house is of the Orthodox sect. Also located on the site is the Haverford Friends School. These buildings, the Orthodox Sect, and the association with Haverford College make up an interesting assemblage of significance, both
 (continue on back if necessary)

4. Survey Code
 045-HA-020

28. Sources of Information
 M.E. Johnston

29. Prepared By:
 S.M. Clark
 K. Wandersee
 30. Date: 12 Feb 88
 Revisions: 9/93

(continue on back if necessary)

PENNSYLVANIA HISTORICAL RESOURCE SURVEY FORM
BUREAU FOR HISTORICAL PRESERVATION Box 1026
PA HISTORICAL & MUSEUM COMMISSION Harrisburg, PA 17120



7. Local Survey Organization

Delaware County Planning Department

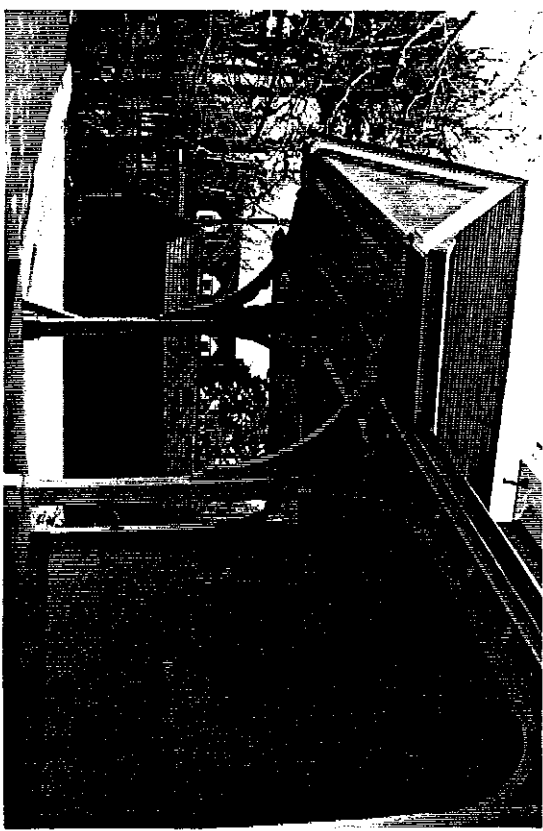
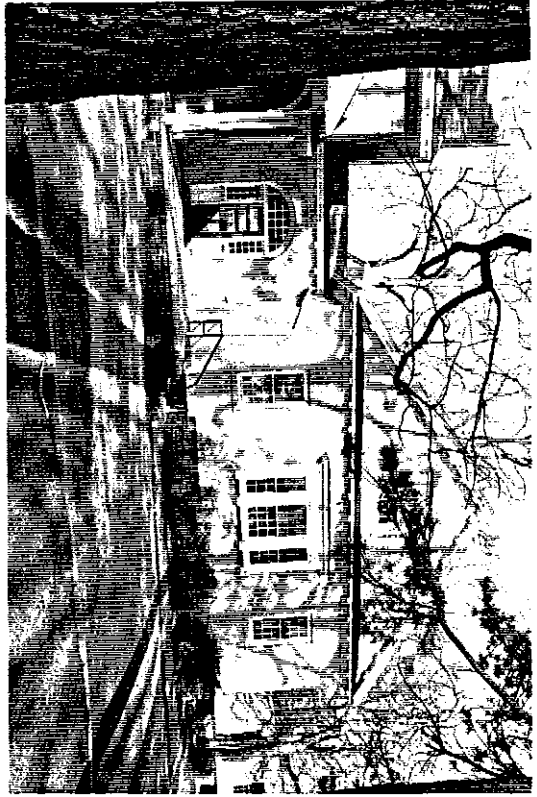
1. County Delaware	2. Municipality Haverford	3. Street Address or Specific Location 851 Buck Lane Haverford, Pa.	4. Survey Code 045-HA-020
5. Present Name Buck Lane Meeting	6. Other Name (historic name if any) Buck Lane Meeting		

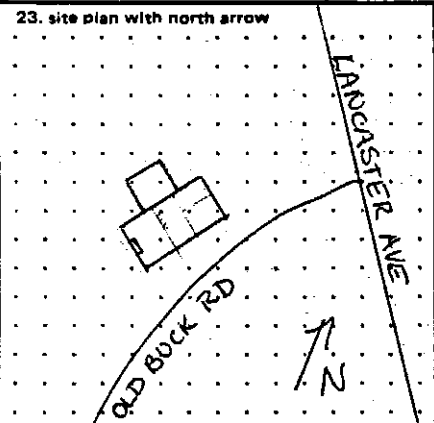

11
12
13
14
15
16
17
18
19
20
21
22
23
24
25
26
27
28
29
30
31
32
33
34
35
36
37
38
39
40
41
42
43
44
45
46
47
48
49
50
51
52
53
54
55
56
57
58
59
60
61
62
63
64
65
66
67
68
69
70
71
72
73
74
75
76
77
78
79
80
81
82
83
84
85
86
87
88
89
90
91
92
93
94
95
96
97
98
99
100
101
102
103
104
105
106
107
108
109
110
111
112
113
114
115
116
117
118
119
120
121
122
123
124
125
126
127
128
129
130
131
132
133
134
135
136
137
138
139
140
141
142
143
144
145
146
147
148
149
150
151
152
153
154
155
156
157
158
159
160
161
162
163
164
165
166
167
168
169
170
171
172
173
174
175
176
177
178
179
180
181
182
183
184
185
186
187
188
189
190
191
192
193
194
195
196
197
198
199
200
201
202
203
204
205
206
207
208
209
210
211
212
213
214
215
216
217
218
219
220
221
222
223
224
225
226
227
228
229
230
231
232
233
234
235
236
237
238
239
240
241
242
243
244
245
246
247
248
249
250
251
252
253
254
255
256
257
258
259
260
261
262
263
264
265
266
267
268
269
270
271
272
273
274
275
276
277
278
279
280
281
282
283
284
285
286
287
288
289
290
291
292
293
294
295
296
297
298
299
300
301
302
303
304
305
306
307
308
309
310
311
312
313
314
315
316
317
318
319
320
321
322
323
324
325
326
327
328
329
330
331
332
333
334
335
336
337
338
339
340
341
342
343
344
345
346
347
348
349
350
351
352
353
354
355
356
357
358
359
360
361
362
363
364
365
366
367
368
369
370
371
372
373
374
375
376
377
378
379
380
381
382
383
384
385
386
387
388
389
390
391
392
393
394
395
396
397
398
399
400
401
402
403
404
405
406
407
408
409
410
411
412
413
414
415
416
417
418
419
420
421
422
423
424
425
426
427
428
429
430
431
432
433
434
435
436
437
438
439
440
441
442
443
444
445
446
447
448
449
450
451
452
453
454
455
456
457
458
459
460
461
462
463
464
465
466
467
468
469
470
471
472
473
474
475
476
477
478
479
480
481
482
483
484
485
486
487
488
489
490
491
492
493
494
495
496
497
498
499
500
501
502
503
504
505
506
507
508
509
510
511
512
513
514
515
516
517
518
519
520
521
522
523
524
525
526
527
528
529
530
531
532
533
534
535
536
537
538
539
540
541
542
543
544
545
546
547
548
549
550
551
552
553
554
555
556
557
558
559
560
561
562
563
564
565
566
567
568
569
570
571
572
573
574
575
576
577
578
579
580
581
582
583
584
585
586
587
588
589
590
591
592
593
594
595
596
597
598
599
600
601
602
603
604
605
606
607
608
609
610
611
612
613
614
615
616
617
618
619
620
621
622
623
624
625
626
627
628
629
630
631
632
633
634
635
636
637
638
639
640
641
642
643
644
645
646
647
648
649
650
651
652
653
654
655
656
657
658
659
660
661
662
663
664
665
666
667
668
669
670
671
672
673
674
675
676
677
678
679
680
681
682
683
684
685
686
687
688
689
690
691
692
693
694
695
696
697
698
699
700
701
702
703
704
705
706
707
708
709
710
711
712
713
714
715
716
717
718
719
720
721
722
723
724
725
726
727
728
729
730
731
732
733
734
735
736
737
738
739
740
741
742
743
744
745
746
747
748
749
750
751
752
753
754
755
756
757
758
759
760
761
762
763
764
765
766
767
768
769
770
771
772
773
774
775
776
777
778
779
780
781
782
783
784
785
786
787
788
789
790
791
792
793
794
795
796
797
798
799
800
801
802
803
804
805
806
807
808
809
810
811
812
813
814
815
816
817
818
819
820
821
822
823
824
825
826
827
828
829
830
831
832
833
834
835
836
837
838
839
840
841
842
843
844
845
846
847
848
849
850
851
852
853
854
855
856
857
858
859
860
861
862
863
864
865
866
867
868
869
870
871
872
873
874
875
876
877
878
879
880
881
882
883
884
885
886
887
888
889
890
891
892
893
894
895
896
897
898
899
900
901
902
903
904
905
906
907
908
909
910
911
912
913
914
915
916
917
918
919
920
921
922
923
924
925
926
927
928
929
930
931
932
933
934
935
936
937
938
939
940
941
942
943
944
945
946
947
948
949
950
951
952
953
954
955
956
957
958
959
960
961
962
963
964
965
966
967
968
969
970
971
972
973
974
975
976
977
978
979
980
981
982
983
984
985
986
987
988
989
990
991
992
993
994
995
996
997
998
999
1000

PENNSYLVANIA HISTORIC RESOURCE SURVEY FORM OFFICE OF HISTORIC PRESERVATION Box 1026 PA HISTORICAL & MUSEUM COMMISSION Harrisburg, PA 17120		7. Local survey organization Delaware County Planning Department		1. County Delaware 2. Municipality Haverford 3. Street address or specific location Old Buck Rd & Lancaster Avenue 4. Survey code 045-HA-21
8. Property owners name and address Main Line Center of the Arts 746 Panmure Road Haverford, PA 19041		9. tax parcel number / other number 22 05 00778 00	10. U.T.M. zone 18 4713171510 11. status (other surveys, lists etc.) None usage sheet: Norristown F	
12. classification site () structure () object () building (x) in N.R. district yes () no (x)	13. date(s) (how determined) ca. 1840 14. period	15. style, design or folk type Federal	19. original use residential 20. present use institutional	
16. architect or engineer	17. contractor or builder	18. primary building mat./construction stucco over stone	21. condition fair 22. integrity minor alterations	
23. site plan with north arrow 				5. other name (historic name if any) White House (later for the Arts)
24. photo notation Roll 390, #37-38		25. file/location DCFD		
26. brief description (note unusual features, integrity, environment, threats and associated buildings) Federal style, 5 bay, three story square stucco over stone house built on 2.66 acres ca. 1840. Exterior and recessed interior shutters on first floor, very high ceilings, five fireplaces. Veranda removed. Carriage house razed, March 1983. One story kitchen wing in rear.				
(continue on back if necessary)				
27. history, significance and/or background Original owner, Ann Margaret Kelly Martin, was the daughter of Dennis Kelly who owned mills on Cobbs Creek. It was her family that owned the Buck Tavern in 1850. Dr. William Martin, her husband, named streets in the area. He named Martin's Road for the family. Significant as adaptive reuse, the house has been an arts center since 1945 when it became the Suburban Center for the Arts. In 1963 it (Cont.)				
(continue on back if necessary)				
28. sources of information M. Johnston; Deeds, St. Denis Sesquicentennial Book 1825-1974 p. 39			29. prepared by: S. Hauser 30. date 6/83 revision(s)	
(continue on back if necessary)				

ADDITIONAL DATA/PHOTOS
number all continuations from front

4. survey code
045-HA-21

27. merged with Bryn Mawr Art Center to become Main Line Center of the Arts.



EVALUATION

EVALUATOR(S)

PENNSYLVANIA HISTORICAL RESOURCE SURVEY FORM BUREAU FOR HISTORICAL PRESERVATION Box 1026 PA HISTORICAL & MUSEUM COMMISSION Harrisburg, PA 17120		7. Local Survey Organization Delaware County Planning Department	
6. Property Owner's Name and Address Deborah MacGregor P.O. Box 576 New Haven, Ct. 06513		9. Tax Parcel Number/Other Number 22-05-00357-00	10. U.T.M. zone easting 18 473040 4428940 U.S.G.S. Sheet: Norristown (F)
12. Resource Count buildings (3) district () sites () structures () objects () intrusions ()		11. Status (Other Surveys, Lists, Etc.)	
13. Date(s) (how determined) 185 Documented		15. Style, Design or Folk Type Federal Vernacular	
14. Period		16. Primary Building Mat./Construction Stucco over Stone covered by Alum.	
16. Architect or Engineer		17. Contractor or Builder	
19. Original Use Worker's Residence		20. Present Use Residence	
21. Condition Good		22. Integrity Altered-major	

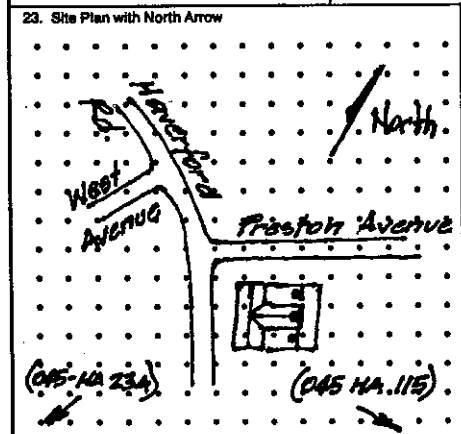

24. Photo Notation
 Roll 390, Fr. 35,36
 Roll 8523, Fr. 30,31

25. File/Location
 DCPD

26. Brief Description (note unusual features, integrity, environment, threats and associated buildings)
 2 story, 2 bay, shallow pitch gable end roof rowhouse composed of three units; attached to rear is 2 sty reverse sloped addition which drains water to center of addition. Front portion is original w/reverse slope addition occurring in 20th century. Original outlines consisted of row with gable tee with end gable chimney offset by shallow flat pitch 2 sty addition with rear elevation side chimney. Front facades consisted of off-centered entries to inside with long entry stoop stretching across front of entries. Windows 6/6 in front and original rear wings. Altered in late 20th C. with addition of aluminum siding over original stone.
(continue on back if necessary)

27. History, Significance and/or Background
 The rowhouse complex while having the original stucco finish covered, retains its history significance through its use. This was mill-worker housing for Haydock Garrigues Mills (see 045-HA-023 A & 115) and for Dennis Kelly and his Castle Hill Mill complex. It is the only mill-worker housing found in the Township to-date that is tied to early Township and County industrial base.
(continue on back if necessary)

28. Sources of Information M. Johnston, Atlases of Delaware County	29. Prepared By: J. Barrett, K. Wandersee S. Clark
30. Date 8 May 87	Revision(s) 1/91 9/93

(continue on back if necessary)

1. County Delaware	2. Municipality Haverford	3. Street Address or Specific Location 721, 723, 725 Haverford Rd Haverford, Pa.	4. Survey Code 045-HA-022
5. Present Name			
6. Other Name (historic name if any)			

